

### LWS-525

## Test Probe for Testing of Optical Fibre Connectors

Reliable Testing of Optical Fibre Connectors: The new LWS-525 conforms optimally for the testing of plug connectors. Possible angle and position errors in contacting are compensated by the free floating plunger. This ensures high return loss and low insertion loss is achieved.

Different versions of the LWS-525 are available depending on the plug connector to be contacted and the appropriate optical fibre diameter. These can also be manufactured on request.



LWS-525

#### Technical Data:

Part No.:	LWS-525
Max. Stroke:	7.0 mm
Recommended Stroke:	5.0 mm
Spring force at working stroke:	3.0 N
LWL-Clip connection-Ø	1.0 mm; 1.55 mm; 2.30 mm
Angle error balance:	up to +/- 2.0°
Position error balance:	up to +/- 0.3 mm

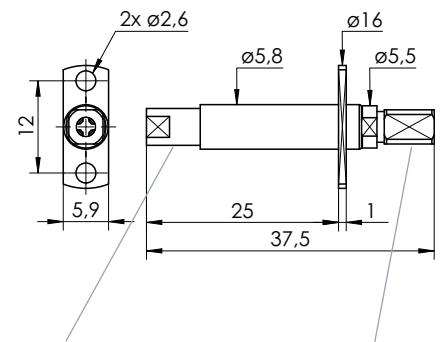

Individual adjustment to  
Optical Fibre Connectors

Clip for Optical  
Fibre Connectors

Please contact us for further information.  
Prices and delivery time on request.  
Technical changes possible without prior notification.

More innovative products can be found on our website or in our Test Probes catalog. Please pay special attention to our variety of Cable Harness Test Probes.

