



Twist-Proof Probes

F75684B0001G150

Order code 1005089

General

Design	Basic Contact Probe
Family	F756
Pitch [mm/mil]	2.54 / 100
Temperature [C°]	-45°C...+200°C

Electrical specifications

Continuous current [A]	5.00
Typical contact resistance [mOhm]	25.00

Mechanical specifications

Preload [cN]	60.00
Spring force [cN]	150.00
Nominal travel [mm]	4.00
Maximum travel [mm]	4.40
Pointing accuracy +/- [mm]	0.08
Thread	M1.6
Tool size [mm]	1.7

Dimensions

Total length [mm]	41.60
Projection height [mm]	10.30
Tip style diameter [mm]	1.50
Barrel diameter [mm]	1.64
Collar diameter [mm]	2.30
Press ring diameter [mm]	2.30

Materials & surfaces

Tip style	84
Plunger material	Beryllium copper
Plunger plating	Gold
Barrel material	Brass
Barrel plating	Gold
Spring material	High-grade steel
Spring plating	Uncoated

Family drawing

All measurements are in mm.

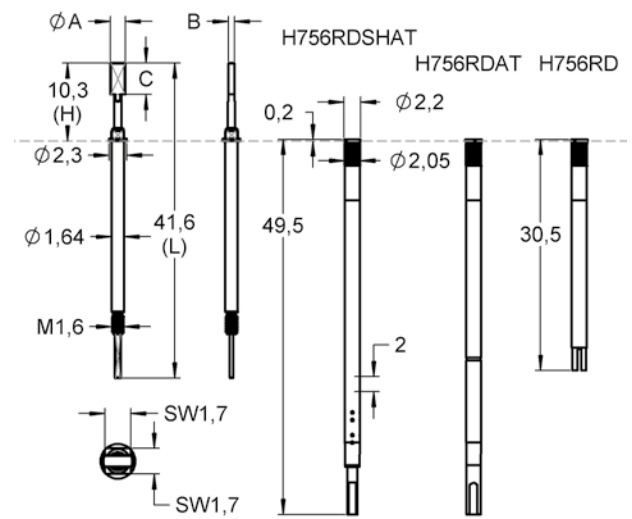

Accessories

Tool for probe	1015305-FWZ732S2,
	1029808-FWZ732S2T
Other	1019498-H756RDATS1,
	1014221-H756RDSHAT,
	1014220-H756RDAT,
	1014219-H756RD,
	1006670-H756AT

Tip style 1

