



High Current Probes

HC160E06G80F

Order code 1116866

General

Design	Coaxial Probe
Family	HC160
Pitch [mm/mil]	18.0 / 708
Temperature [C°]	-45°C...+200°C
Additional definition	D

Electrical specifications

Continuous current [A]	200.00
Typical contact resistance [mOhm]	0.20
Continuous current 2 [A]	5.00
Typical contact resistance 2 [mOhm]	30.00

Inner contact specifications

Nominal travel 2 [mm]	2.20
Maximum travel 2 [mm]	4.40
Preload 2 [cN]	130.00
Spring force 2 [cN]	400.00

Mechanical specifications

Preload [cN]	3500.00
Spring force [cN]	8000.00
Nominal travel [mm]	4.00
Maximum travel [mm]	6.00
Tool size [mm]	15/12
Connection type (flux-proof)	Thread

Dimensions

Total length [mm]	42.20
Projection height [mm]	2.20
Tip style diameter [mm]	16.00
Barrel diameter [mm]	13.80
Collar diameter [mm]	25.00
Inside/outside distance [mm]	2.20
Tip style diameter 2 [mm]	1.30

Family drawing

All measurements are in mm.

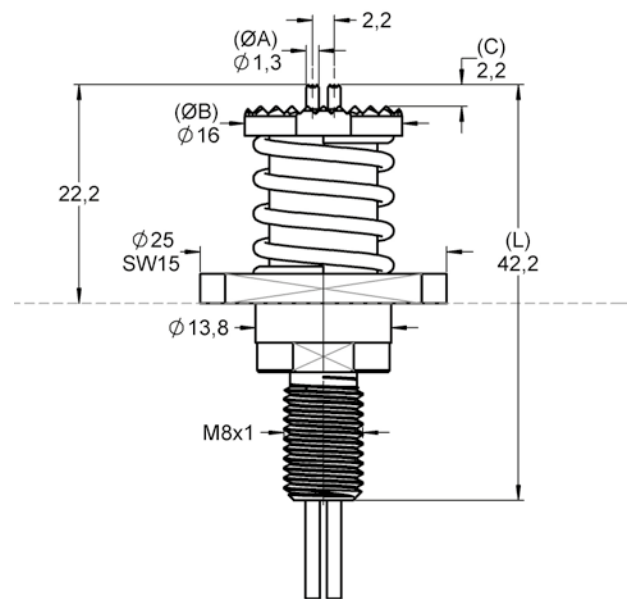

Thermal Rise of Contact Probe vs. Current

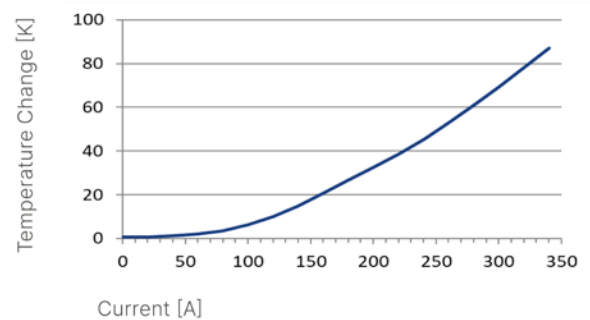

Materials & surfaces

Tip style	06
Tip style 2	06
Tip style material	Beryllium cooper
Tip style plating	Gold
Plunger material	Brass
Plunger plating	Silver
Barrel material	Plastic
Barrel plating	Uncoated
Spring material	High-grade steel
Spring plating	Uncoated
Plunger material 2	Beryllium copper
Plunger plating 2	Gold
Spring material 2	High-grade steel
Spring plating 2	Uncoated

Tip style 1

