



High Current Probes

HCF36011B130G080

Order code 1012191

General

Design	Basic Contact Probe
Family	HCF360
Pitch [mm/mil]	3.70 / 145
Temperature [C°]	-45°C...+200°C

Electrical specifications

Continuous current [A]	15.00
Typical contact resistance [mOhm]	15.00

Mechanical specifications

Preload [cN]	50.00
Spring force [cN]	80.00
Nominal travel [mm]	0.80
Maximum travel [mm]	1.20
Pointing accuracy +/- [mm]	0.10
Thread	M2.5
Tool size [mm]	2.2

Dimensions

Total length [mm]	4.90
Projection height [mm]	2.40
Tip style diameter [mm]	1.30
Barrel diameter [mm]	2.50
Collar diameter [mm]	2.80
Press ring diameter [mm]	2.80

Materials & surfaces

Tip style	11
Plunger material	Beryllium copper
Plunger plating	Gold
Barrel material	Brass
Barrel plating	Gold
Spring material	High-grade steel
Spring plating	Uncoated

Family drawing

All measurements are in mm.

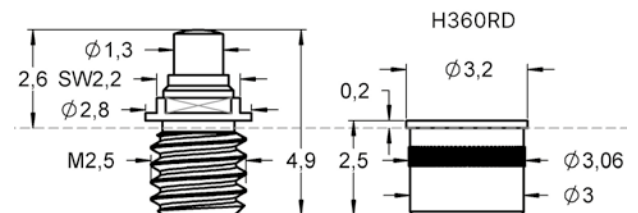

Thermal Rise of Contact Probe vs. Current

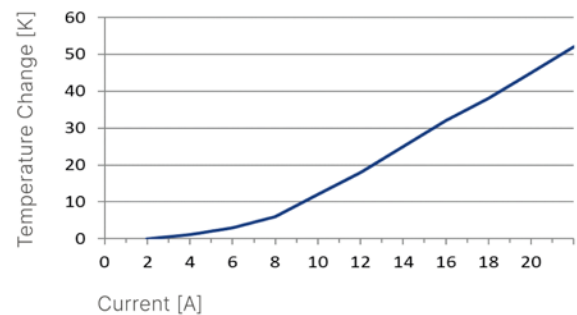

Accessories

Tool for probe	1029836-FWZVF3S2T, 1005893-FWZVF3S2
Other	1026723-H360RD

Tip style 1

