



HCF71306B230G150

Order code 1024197

Design	Basic Contact Probe
Family	HCF713
Pitch [mm/mil]	4.00 / 157
Temperature [C°]	-45°C...+200°C

Continuous current [A]	30.00
Typical contact resistance [mOhm]	8.00

Preload [cN]	70.00
Spring force [cN]	150.00
Nominal travel [mm]	2.80
Maximum travel [mm]	3.50
Pointing accuracy +/- [mm]	0.10

Total length [mm]	15.00
Projection height [mm]	7.10
Tip style diameter [mm]	2.30
Barrel diameter [mm]	2.65
Collar diameter [mm]	3.20
Press ring diameter [mm]	3.20

Tip style	06
Plunger material	Beryllium copper
Plunger plating	Gold
Barrel material	Brass
Barrel plating	Gold
Spring material	High-grade steel
Spring plating	Uncoated

Other	1131050-HP265LA, 1018232-H713LA
-------	------------------------------------

All measurements are in mm.

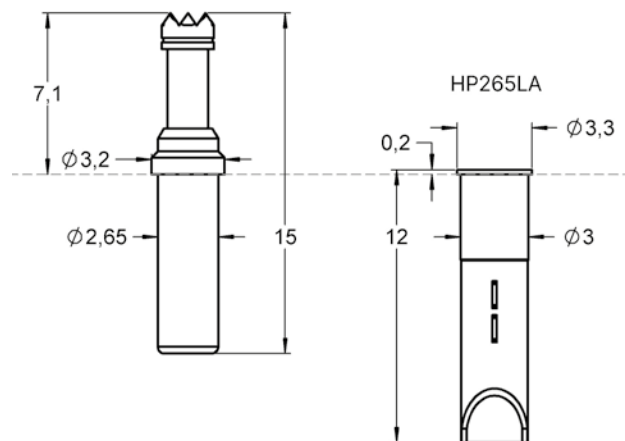

The graph shows the temperature change of a 100 W incandescent lamp as a function of current. The x-axis represents Current [A] from 0 to 40, and the y-axis represents Temperature Change [K] from 0 to 120. A blue curve starts at (0,0) and rises to approximately (40, 58). A horizontal line is drawn at 40 K.

Current [A]	Temperature Change [K]
0	0
4	0
8	2
12	8
16	15
20	22
24	30
28	38
32	45
36	52
40	58

Tip style 1

